



P - Instruções de montagem F - Instructions de montage E - Instrucciones de montaje
 GB - Installation instructions D - Montageanweisungen

Watt	C	L	A	F1
1 x 				
18/14/24	680	105	95	464
36/28/54	1288	105	95	843
58/35/49/80	1576	105	95	922
2 x 				
18/14/24	680	140	95	464
36/28/54	1288	140	95	843
58/35/49	1576	140	95	922



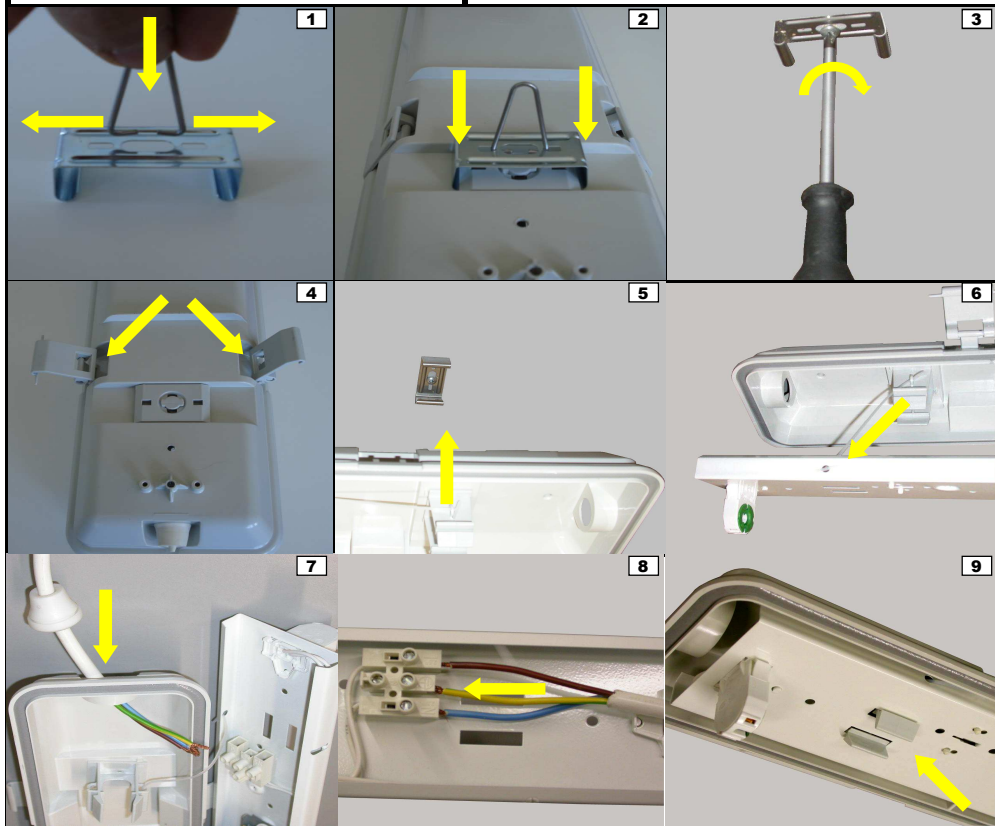
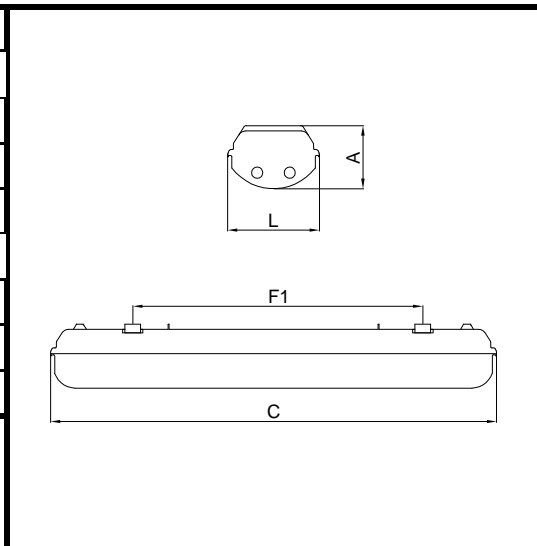
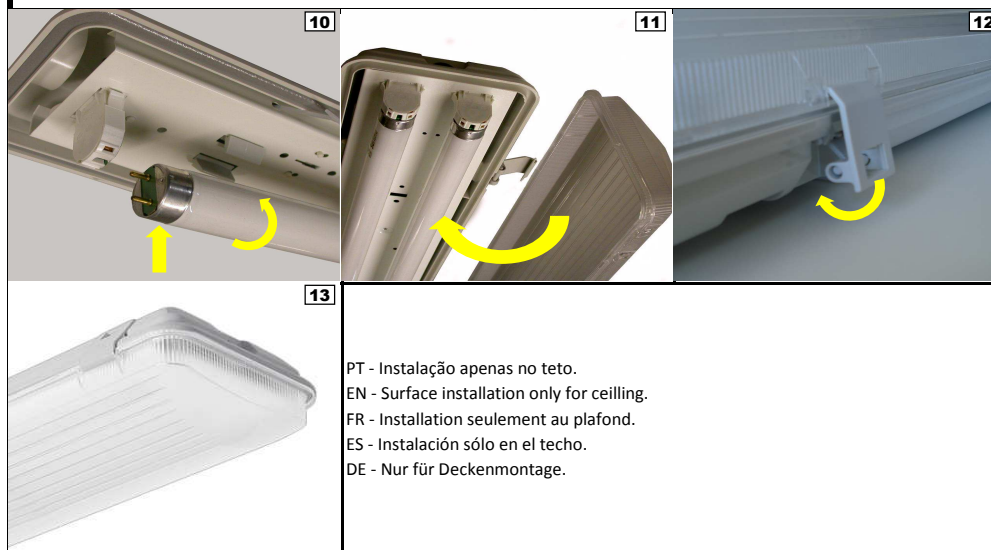

P - Instruções de montagem F - Instructions de montage E - Instrucciones de montaje
 GB - Installation instructions D - Montageanweisungen

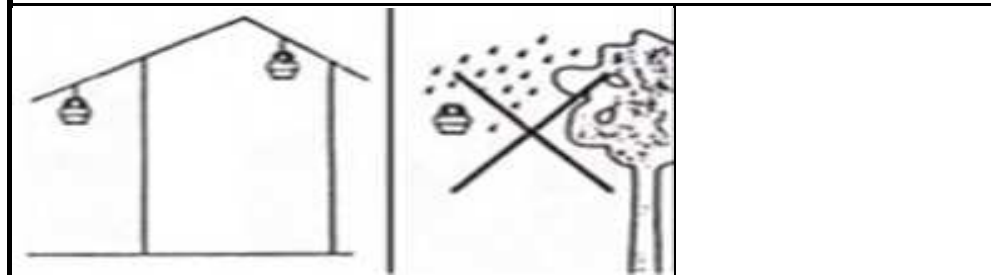

PT - Esta luminária não pode ser instalada em locais que existam óleos ou vapores de óleos minerais e/ou vegetais
 EN - This luminaire should not be installed in rooms where oil is manipulated or where there is mineral and/or vegetable oil vapour.
 FR - Ce luminaire ne doit pas être installé dans des locaux où il peut exister des huiles ou des vapeurs d'huiles minérales et végétales.
 ES - Esta luminaria no debe instalarse en locales donde existan aceites o vapores de aceites minerales y vegetales.
 DE - Diese Leuchte darf nicht in Räumen, in denen Öl manipuliert wird oder wo Mineral- oder / und Pflanzenöl Dampf existiert, installiert werden.



P - Instruções de montagem	F - Instructions de montage	E - Instrucciones de montaje			
GB - Installation instructions	D - Montageanweisungen				
Watt	C	L	A	F1	
1 x 					
18/14/24	680	105	95	464	
36/28/54	1288	105	95	843	
58/35/49/80	1576	105	95	922	
2 x 					
18/14/24	680	140	95	464	
36/28/54	1288	140	95	843	
58/35/49	1576	140	95	922	

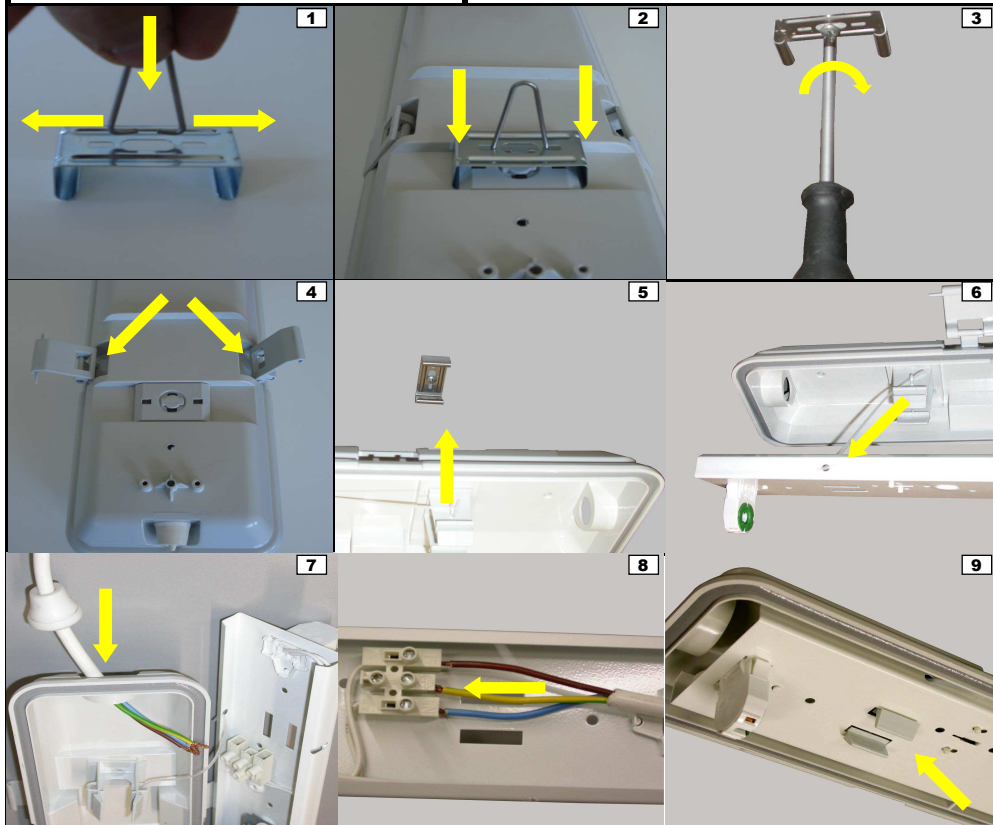
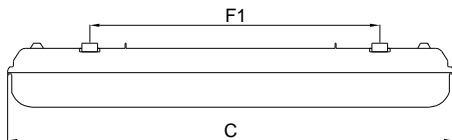
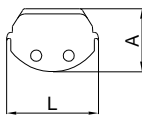

P - Instruções de montagem	F - Instructions de montage	E - Instrucciones de montaje
GB - Installation instructions	D - Montageanweisungen	

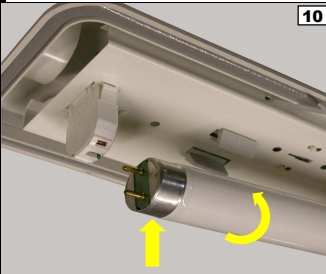

10



11

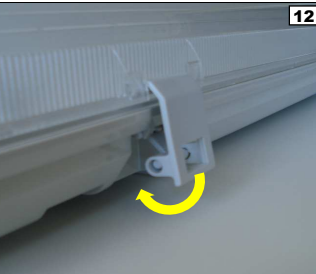

12



13

PT - Instalação apenas no teto.
 EN - Surface installation only for ceiling.
 FR - Installation seulement au plafond.
 ES - Instalación sólo en el techo.
 DE - Nur für Deckenmontage.

PT - Esta luminária não pode ser instalada em locais que existam óleos ou vapores de óleos minerais e/ou vegetais
 EN - This luminaire should not be installed in rooms where oil is manipulated or where there is mineral and/or vegetable oil vapour.
 FR - Ce luminaire ne doit pas être installé dans des locaux où il peut exister des huiles ou des vapeurs d'huiles minérales et végétales.
 ES - Esta luminaria no debe instalarse en locales donde existan aceites o vapores de aceites minerales y vegetales.
 DE - Diese Leuchte darf nicht in Räumen, in denen Öl manipuliert wird oder wo Mineral-oder / und Pflanzenöl Dampf existiert, installiert werden.

